



## Designer Aquarium Stand Assembly Instructions

### Size 29/32

20.5" Wide x 21" Deep x 29" High  
Item # 100531924

***Easy to  
assemble!***

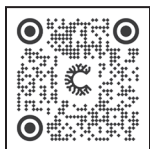

For questions or inquiries about  
this product, please visit us online at  
[coralife.com](http://coralife.com) or call **888-255-4527**

Coralife and BioCube are registered trademarks  
of Central Garden & Pet Company  
©2023 Central Garden & Pet Company  
[coralife.com](http://coralife.com) Nov2023 Made in China

# Parts Diagram

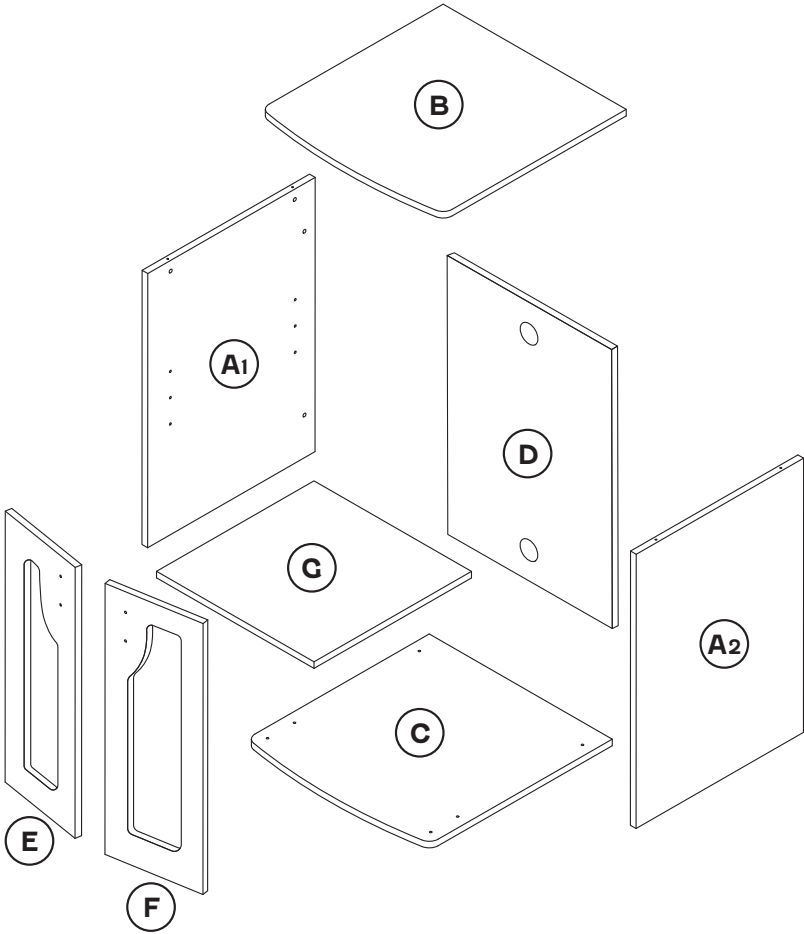

## Tools Required for Assembly

Phillips screwdriver, hammer and level.

## Parts Identification

While not all parts are labeled, some of the parts will have a label or an inked letter on the edge to help distinguish similar parts from each other. Use this PARTS IDENTIFICATION to help identify similar parts.

Part	Item Description	Qty.
A1	LEFT END	1
A2	RIGHT END	1
B	TOP	1
C	BOTTOM	1
D	BACK	1
E	LEFT DOOR	1
F	RIGHT DOOR	1
G	ADJUSTABLE SHELF	1

Part #	Item Description	Qty.
1	FOOT	4
2	GOLD 2-1/4" FLATHEAD SCREW	4
3	GOLD CAM SCREW	8
4	SILVER HIDDEN CAM	8
5	MAGNETIC CATCH	2
6	SILVER 1/2" FLATHEAD SCREW	12
7	PIVOT HINGE	4
8	STRIKE PLATE	2
9	HANDLE	2
10	GOLD 1" MACHINE SCREW	4
11	METAL PIN	4
12	GOLD 1" FLATHEAD SCREW	4

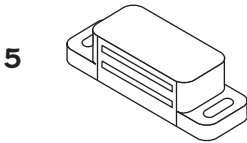
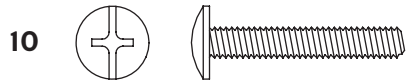
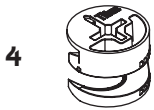
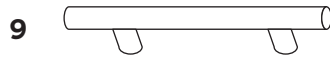
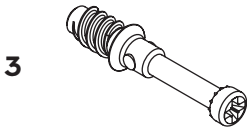
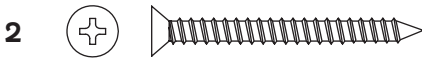
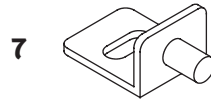
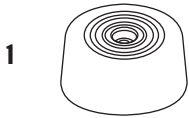

# Assembly

## STEP 1

1. Assemble the unit on a carpeted floor or on the empty carton to avoid scratching the unit or the floor.
2. Using a cross head screwdriver, screw the 4 screws (12) through the feet (1) into the holes in the bottom (C).

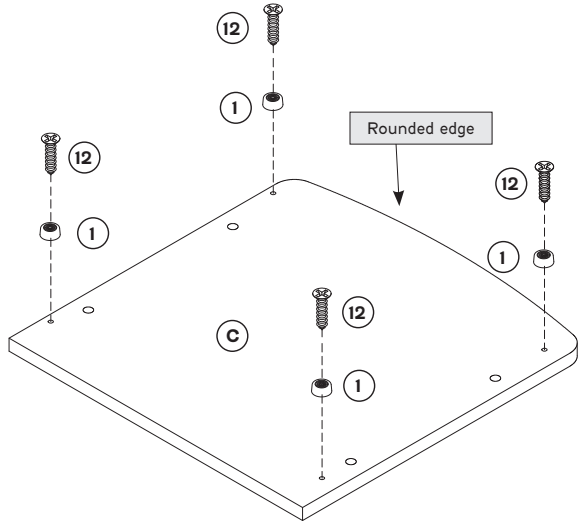

## STEP 2

1. Attach the bottom (C) to the left end (A1). Use two gold 2-1/4" flathead screws (2).

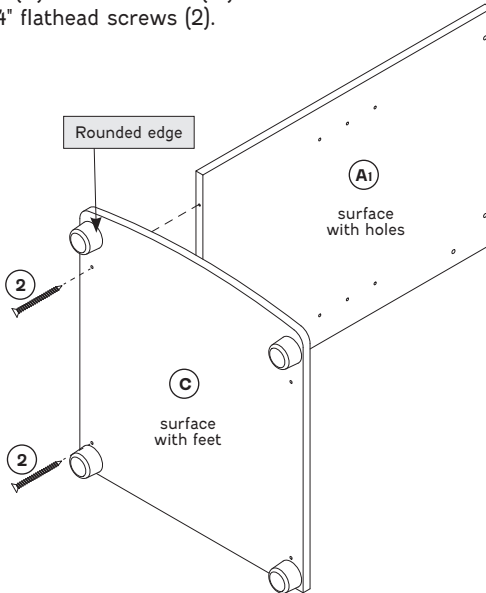

### STEP 3

1. Turn two gold cam screws (3) into the left end (A1).
2. Push two silver hidden cams (4) into the back (D).

**NOTE:** The side with the silver hidden cams (4) should be facing out so they are visible on the back of the stand.

3. Attach back (D) to the left end (A1).
4. Tighten the silver hidden cams (4).

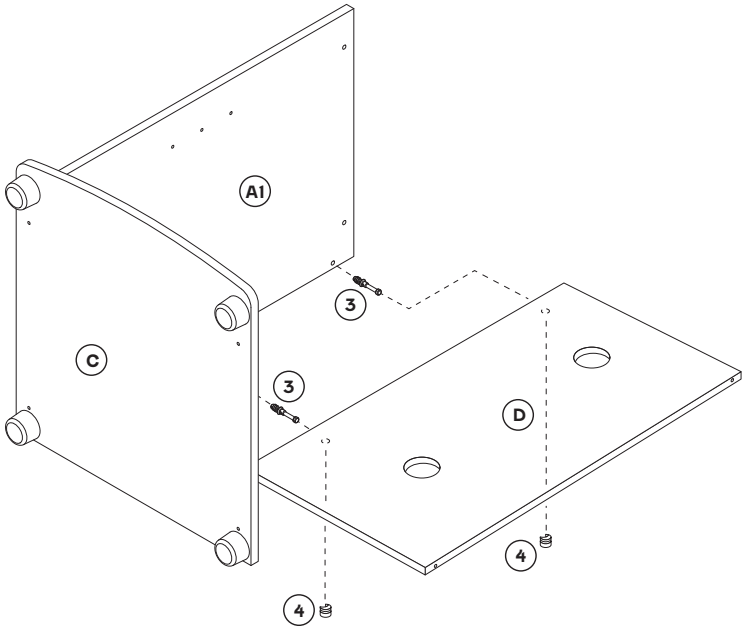

## STEP 4

1. Turn two gold cam screws (3) into the right end (A2).
2. Push two silver hidden cams (4) into the back (D).

**Note:** The side with the silver hidden cams (4) should be facing out so they are visible on the back of the stand.

3. Attach the bottom (C) to the right end (A2). Use two gold 2-1/4" flathead screws (2).

**Note:** Make sure to attach gold cam screws (3) from the right end (A2) panel into the back (D).

4. Tighten the silver hidden cams (4) on the back (D) panel.

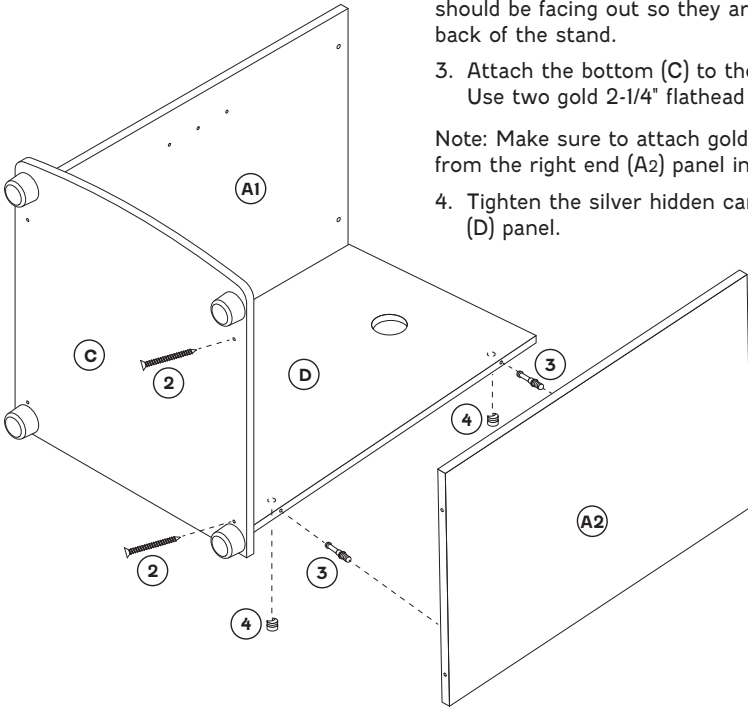

## STEP 5

1. Attach the magnetic catches (5) to the holes in the top (B). Use four silver 1/2" flat head screws (6).
2. Turn four gold cam screws (3) into the top (B).

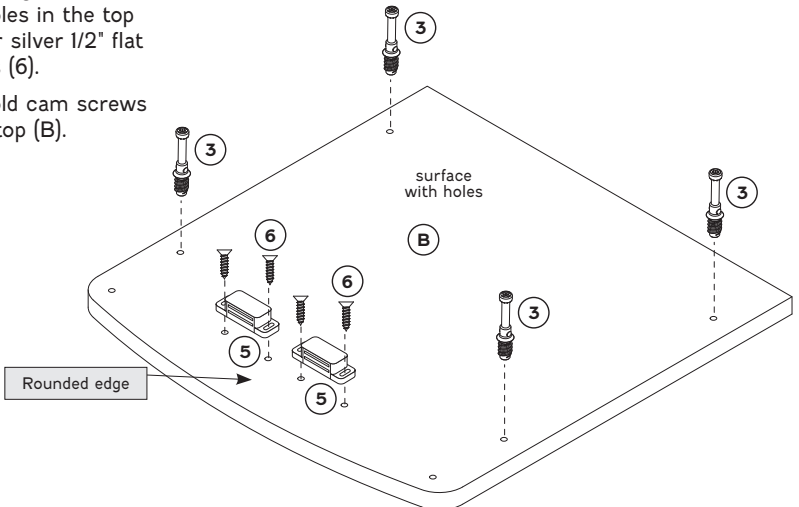

## STEP 6

1. Push two silver hidden cams (4) into the left end (A1) and right end (A2).
2. Fasten the top (B) to the ends (A1, A2). Tighten the four silver hidden cams (4).

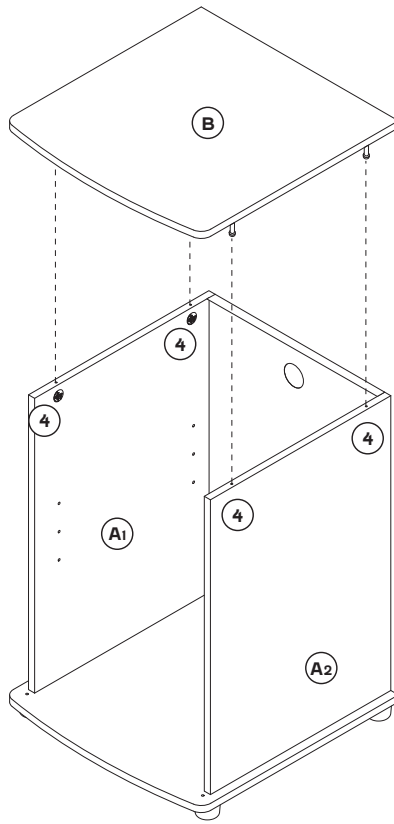

## STEP 7

**IMPORTANT:** only attach one pivot hinge (7) to door (E) and door (F) in this step.

1. Fasten one of the pivot hinges (7) to the door (E). Use a silver 1/2" flathead screw (6). Completely tighten this screw.
2. Attach the strike plate (8) to the door (E). Use two silver 1/2" flathead screws (6).
3. Repeat #1 and #2 for door (F).

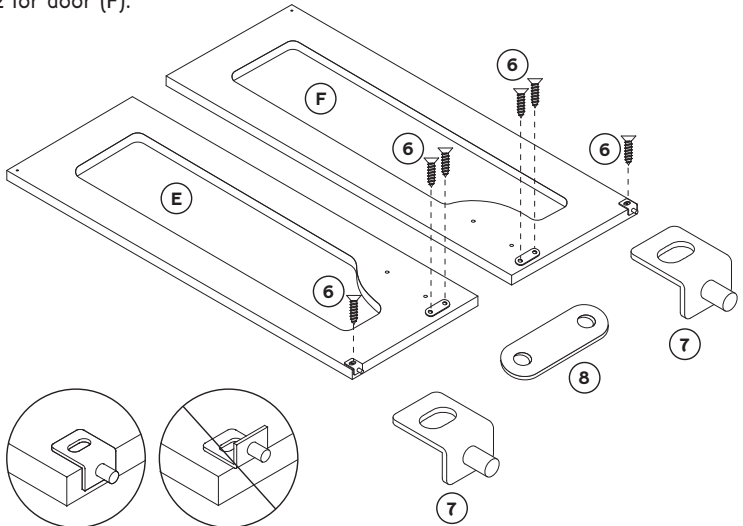

## STEP 8

1. Insert the remaining pivot hinges (7) into the bottom (C).
2. Insert the top pivot hinge (7), which is attached to the door (E), all the way into the hole in the top (B). You will need to tilt the door slightly.
3. Now, tip the door in and attach the bottom pivot hinge (7) to the door (E). Use a silver 1/2" flathead screw (6).
4. Repeat #2 and #3 for door (F).

**NOTE:** To make adjustments to the door, loosen the screw in the hinge, make needed adjustments and tighten the screw.

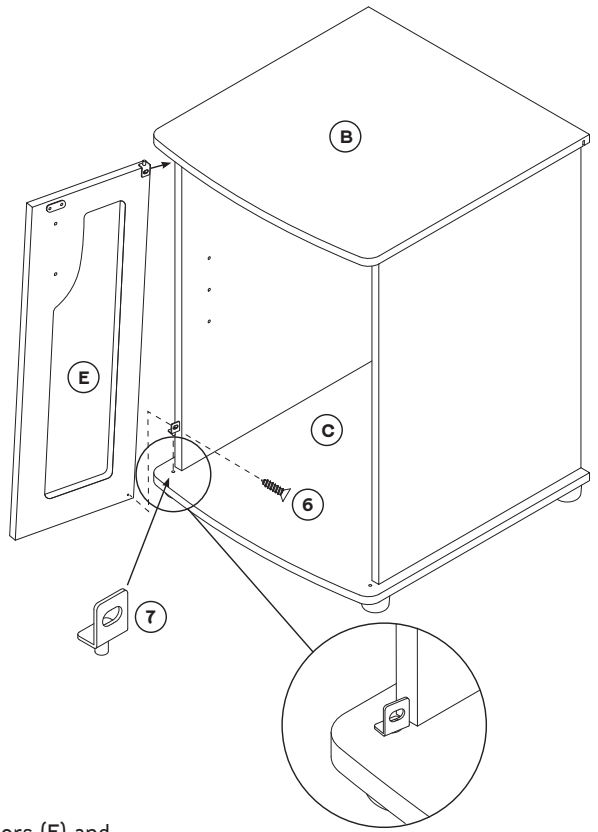

## STEP 9

1. Attach the handles (9) to the doors (E) and (F). Use four gold 1" machine screws (10).
2. Insert metal pins (11) into the hole locations of your choice in the ends (A<sub>1</sub>, A<sub>2</sub>). Set the adjustable shelf (C) onto the metal pins (11).
3. In a suitable location, place the unit on a flat surface. Level the unit by placing a leveling tool on the top and take readings from front to back and side to side.
4. This completes assembly. Clean with your favorite furniture polish or a damp cloth. Wipe dry.

